

RE 18 136-04/09.02

Replaces: 07.01

**3/2-way spool valves
with solenoid operation
Type KKDER1**

Build size 1

Cavity: T-11A

Maximum operating pressure 350 bar

Maximum flow 60 L/min



H/A/D 6810/01

Type KKDER1CA/HC ...

Overview of contents

Contents	Page
Features	1
Ordering details	2
Function, section, symbol	3
Technical data	4
Characteristic curves, performance limits	5
Unit dimensions, cavities	6
Available individual components	7

Features

- Direct operated directional spool valve with solenoid operation
- Flow can be passed in both directions
- Wet pin DC solenoids
- The solenoid coil can be rotated
- With protected hand override



© 2002
by Bosch Rexroth AG, Industrial Hydraulics, D-97813 Lohr am Main

All rights reserved. No part of this document may be reproduced or stored, processed, duplicated or circulated using electronic systems, in any form or by any means, without the prior written authorisation of Bosch Rexroth AG. In the event of contravention of the above provisions, the contravening party is obliged to pay compensation.

This document was prepared with the greatest of care, and all statements have been examined for correctness. This document is subject to alterations for reason of the continuing further developments of products. No liability can be accepted for any incorrect or incomplete statements.

Ordering details

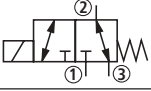
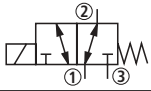
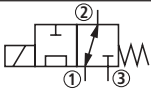
KKDER		R	1	A / H	C	V
Direct operated directional spool valve, electrically operated						V = FKM seals
Max. operating pressure 350 bar		= R				K4 = ISO 4400 ²⁾
Build size		= 1				K40 = Deutsch plug ²⁾
						C4 = 2-pin type Junior-Timer ²⁾
						N0 = Without hand override
						N9 = Protected hand override
Cavity ¹⁾	Pressure 350 bar	Symbols	Actuator connections			
	$q_v = L/min$			3		
T-11A	60		= C	C = Wet pin DC solenoid with removable coil		
			= U	H = High performance and a T-xxA cavity		
			= G	A = Series		

¹⁾ See page 6

²⁾ Without plug-in connector!
Plug-in connectors must be ordered separately (see below)

³⁾ Other voltages on request

Preferred types

Material No.	Type
00728463	KKDER1CA/HCG24N0K4V
00728465	KKDER1UA/HCG24N0K4V
00728467	KKDER1GA/HCG24N0K4V

Plug-in connectors

	Without circuitry Material No.	With circuitry Material No.	
K4 to DIN EN 17530-803 and ISO 4400; for further technical data see RE 08006	00074684	00057292 With indicator light 12...240 V	00310995 With indicator light and Z-diode protective circuit 24 V
C4	00221496		
K40	00733451		

Function, section, symbol

Basic principle:

The cartridge solenoid operated valves are direct operated pressure balanced 3/2-way spool valves. They control the start, stop and direction of a flow.

The cartridge valve basically comprises of a housing (5), bush (6) – that can move within the housing (5) a control spool (9) as well as a return spring (8).

In the de-energised condition the control spool (9) is held in its initial position by the return spring (8). The control spool (9) is actuated via

the wet pin solenoid (7). The various symbols are obtained by using the appropriate spool (C; U and G). Ports 1, 2 and 3 can be continuously applied with an operating pressure of 350 bar and the flow can be passed in both directions (see symbols).

The hand override (4) makes it possible to switch the valve without energising the solenoid. Preferably port 1 is to be used for the pump, port 2 for the actuator and port 3 for the tank connection.

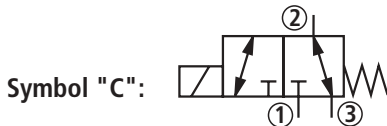

Version K4:

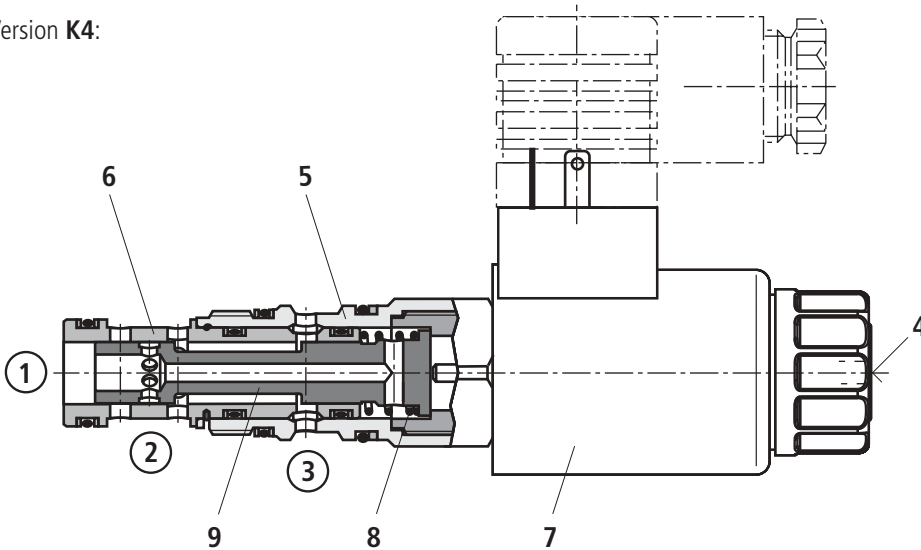

Version C4:

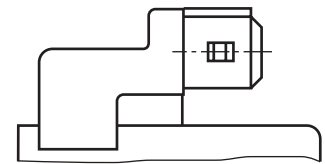

Version K40:

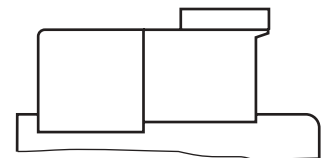

Technical data (for applications outside these parameters, please consult us!)

General

Installation		Optional
Ambient temperature range	°C	- 30 to + 50
Weight	kg	0.6

Hydraulic

Maximum operating pressure	bar	350 at all connections
Maximum flow	L/min	60
Pressure fluid		Mineral oil (HL, HLP) to DIN 51 524; Fast bio-degradable pressure fluids to VDMA 24 568 (see also RE 90 221); HETG (rape seed oil); HEPG (polyglycols); HEES (synthetic ester); Other pressure fluids on request
FKM seals		
Pressure fluid temperature range	°C	- 20 to + 80 (with FKM seals)
Viscosity range	mm ² /s	2.8 to 500
Degree of contamination		Maximum permissible degree of contamination of the pressure fluid is to ISO 4406 (c) class 20/18/15. ¹⁾

Electrical

Voltage type		DC
Available voltages ²⁾	V	24 12
Voltage tolerance (nominal voltage)	%	±10
Power consumption	W	19
Duty		Continuous
Switching time to ISO 6403 (solenoid horizontal)	ON	ms ≤ 80
	OFF	ms ≤ 50
Switching frequency	cycles/h	Up to 15000
Protection to DIN 40 050	K4	IP 65 (with mounted and fixed plug-in connector)
	C4	IP 67 (with mounted and fixed plug-in connector)
	K40	IP 69K (with mounted and fixed plug-in connector)
Maximum coil temperature ³⁾	°C	150

¹⁾ The cleanliness class stated for the components must be adhered to in hydraulic systems. Effective filtration prevents faults from occurring and at the same time increases the component service life
For the selection of filters see catalogue sheets RE 50 070, RE 50 076 and RE 50 081.

²⁾ Further voltages on request.

³⁾ Due to the occurring surface temperature of the solenoid coils, the European Standards EN563 and EN982 must be taken into account!

When connecting the electrics, the protective conductor (PE $\frac{1}{2}$) must be connected according to the relevant regulations.

Characteristic curves (measured with HLP46, $\vartheta_{oil} = 40\text{ °C} \pm 5\text{ °C}$ and 24 V coil)

Δp - q_V -characteristic curves – Symbol C

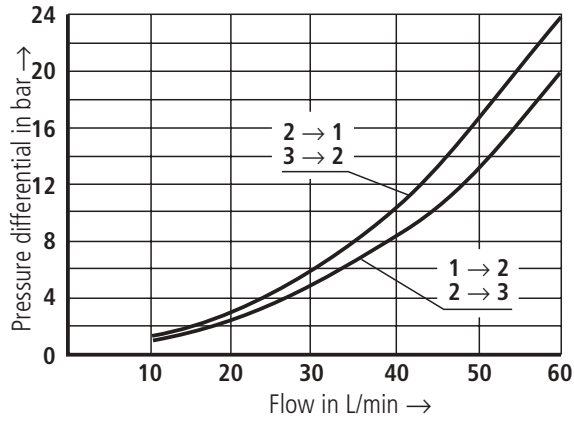

Δp - q_V -characteristic curves – Symbol U

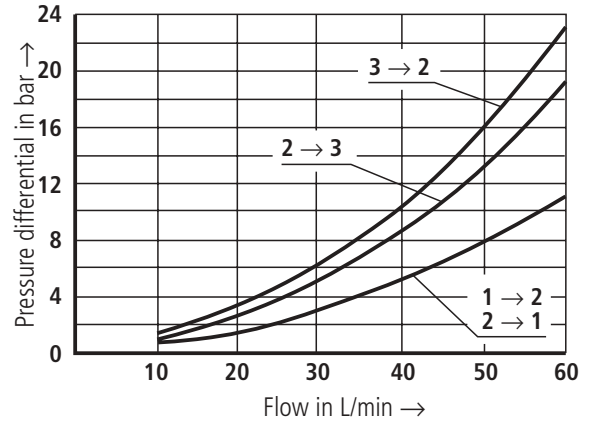

Δp - q_V -characteristic curves – Symbol G

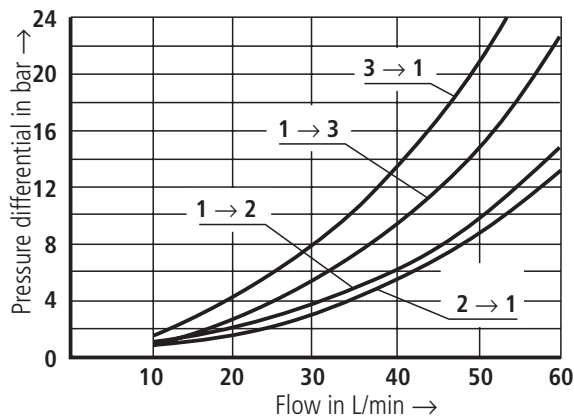

Performance limits (measured with HLP46, $\vartheta_{oil} = 40\text{ °C} \pm 5\text{ °C}$ and 24 V coil)

Symbol C

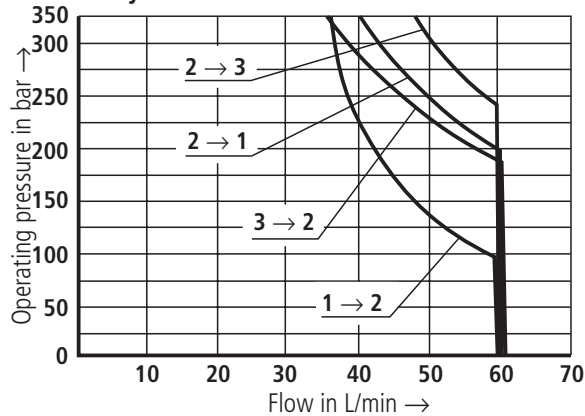

Symbol U

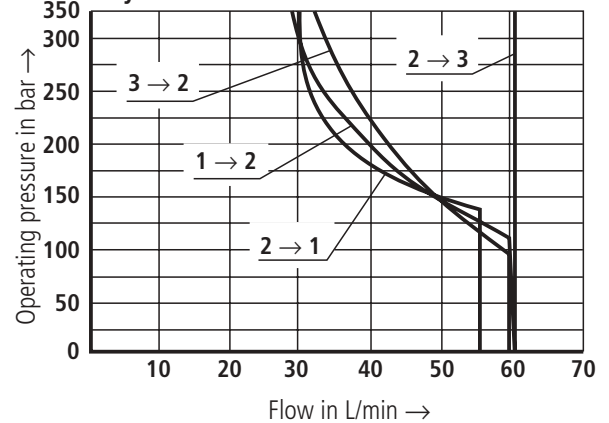

Symbol G

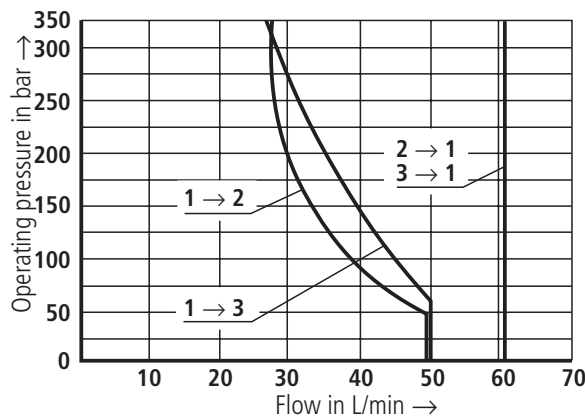

⚠ Attention! The performance limit was determined with the solenoids at their operating temperature and 10% under voltage.

Available individual components

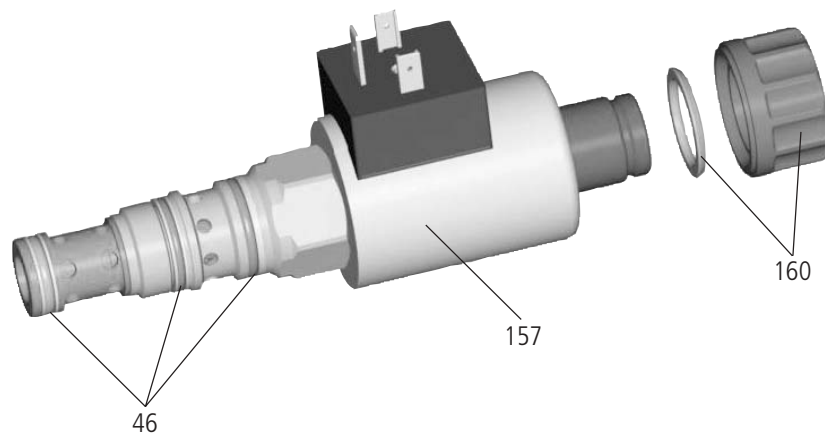

Pos.	Designation		DC voltage	Material No.
157	Coil for individual connection	K4	12 V	00991678
			24 V	00991121
		K40	12 V	00729189
			24 V	00729190
		C4	12 V	00315818
			24 V	00315819
160	Nut			00991453
	O-ring for pole tube			00004280
46	Valve seal kit			00733765

Bosch Rexroth AG
Industrial Hydraulics

D-97813 Lohr am Main
Zum Eisengießer 1 • D-97816 Lohr am Main
Telefon 0 93 52 / 18-0
Telefax 0 93 52 / 18-23 58 • Telex 6 89 418-0
eMail documentation@boschrexroth.de
Internet www.boschrexroth.de

Bosch Rexroth Limited

Cromwell Road, St Neots,
Cambs, PE19 2ES
Tel: 0 14 80/22 32 56
Fax: 0 14 80/21 90 52
E-mail: info@boschrexroth.co.uk

The data specified above only serve to describe the product. No statements concerning a certain condition or suitability for a certain application can be derived from our information. It must be remembered that our products are subject to a natural process of wear and ageing.