

Solenoid valves MN1H, ISO 5599-1

FESTO

Technical data – 5/3-way valves

Flow rate

1200 ... 4600 l/min

Voltage

24 V DC

110, 230 V AC



General technical data						
ISO size	1		2		3	
Valve function	5/3-way, double solenoid					
Constructional design	Piston spool					
Sealing principle	Soft					
Actuation type	Electrical					
Type of reset	Mechanical spring					
Type of pilot control	Piloted					
Pilot air supply	Internal					
Direction of flow	Non-reversible					
Exhaust function	With flow control					
Manual override	Via accessory, detenting					
Type of mounting	Via through-holes					
Mounting position	Any					
Nominal size	[mm]	8	11	14.5		
Standard nominal flow rate	Closed	[l/min]	1200	2300	4100	
	Exhausted	[l/min]			4600	
	Pressurised	[l/min]			4000	
Grid dimension	[mm]	43	56	71		
Pneumatic connection on sub-base		G $\frac{1}{4}$	G $\frac{3}{8}$	G $\frac{1}{2}$		
Product weight	[g]	650	940	1170		
Noise level	[dB (A)]	85				
Certification	Germanischer Lloyd					

Operating and environmental conditions			
Operating medium	Compressed air in accordance with ISO 8573-1:2010 [7:4:4]		
Pilot medium	Compressed air in accordance with ISO 8573-1:2010 [7:4:4]		
Note on operating/pilot medium	Operation with lubricated medium possible (in which case lubricated operation will always be required)		
Operating pressure	Internal pilot air supply	[bar]	3 ... 10
	External pilot air supply	[bar]	-0.9 ... +16
Pilot pressure	[bar]	3 ... 10	
Ambient temperature	[°C]	-10 ... +50	
Temperature of medium	[°C]	-10 ... +50	

Valve response times [ms]						
ISO size	1		2		3	
	On	Off	On	Off	On	Off
With N1 solenoid coil						
Closed	20	44	33	82	33	82
Exhausted	20	46	36	84	36	84
Pressurised	20	46	35	78	35	78

Solenoid valves MN1H, ISO 5599-1



Technical data – 5/3-way valves

Electrical data			
N1 solenoid coil			
Electrical connection		Plug, square design to EN 175301-803, type A	
Operating voltage	D.C. voltage	[V DC]	24
	A.C. voltage	[V AC]	110/230 (50 ... 60 Hz)
Coil characteristics	D.C. voltage	[W]	2.5
	A.C. voltage	[VA]	Pull: 7.5 Hold: 5
Protection class to EN 60 529		IP65	

Materials

Sectional view

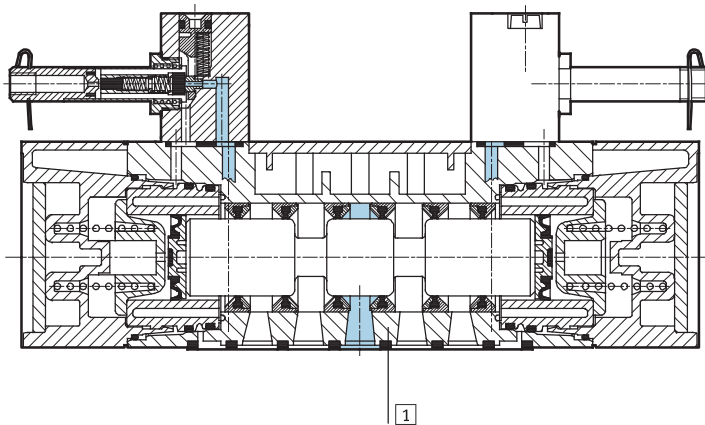

1	Housing	Die-cast aluminium, polyacetate
-	Seals	Nitrile rubber

Solenoid valves MN1H, ISO 5599-1

Technical data – 5/3-way valves



Dimensions

Download CAD Data → www.festo.com/us/cad

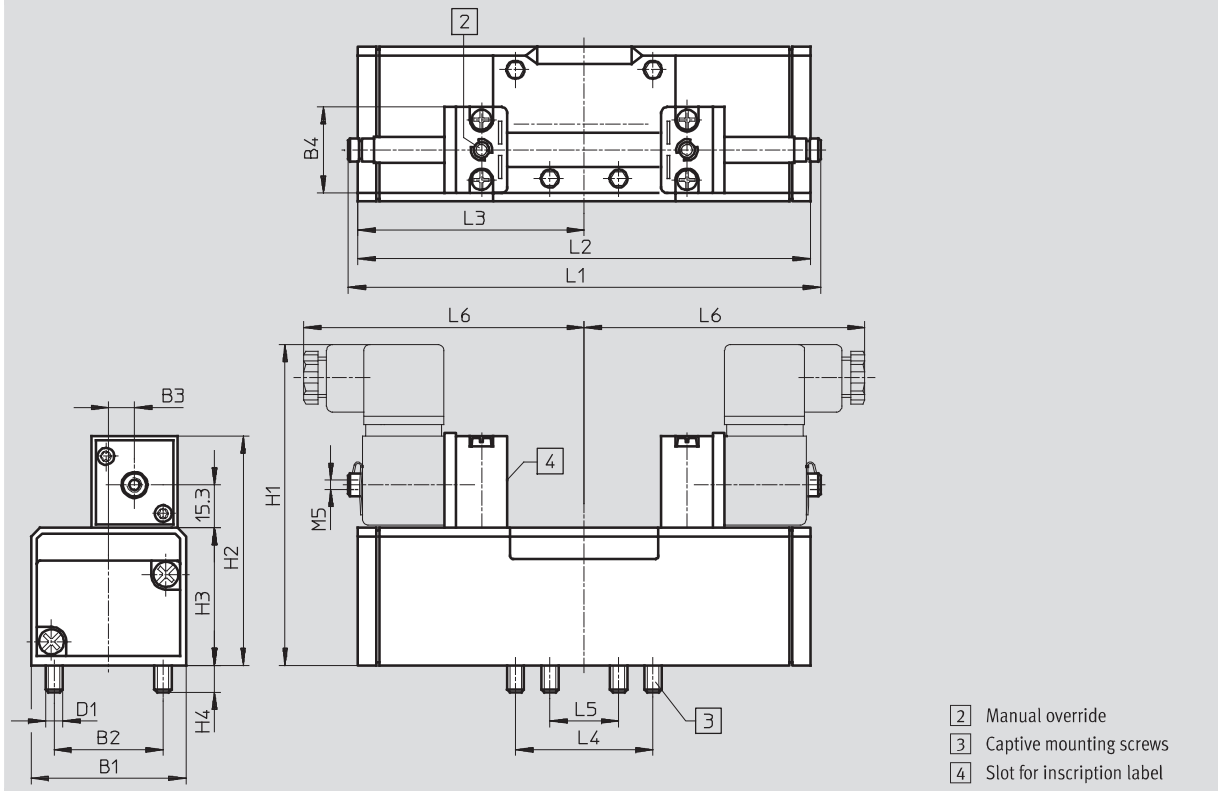

ISO size	B1	B2	B3	B4	D1	H1	H2	H3	H4	L1	L2	L3	L4	L5	L6
1	42	28	6	30	M5	106	74	38	9	147.3	108.4	54.2	36	18	89
2	54	38	9	30	M6	116	84	48	9.5	165	158	79	48	24	98
3	65	48	12	30	M8	123	91	55	12	185.7	184	92	64	32	109

Solenoid valves MN1H, ISO 5599-1



Technical data – 5/3-way valves

Ordering data				
Circuit symbol	Description	ISO size	Part No.	Type
	Without N1 solenoid coil ¹⁾ , normally closed, internal pilot air supply	1	159681	MN1H-5/3G-D-1-C
		2	159693	MN1H-5/3G-D-2-C
		3	159705	MN1H-5/3G-D-3-C
	Without N1 solenoid coil ¹⁾ , normally closed, external pilot air supply	1	159680	MN1H-5/3G-D-1-S-C
		2	159692	MN1H-5/3G-D-2-S-C
		3	159704	MN1H-5/3G-D-3-S-C
	Without N1 solenoid coil ¹⁾ , normally exhausted, internal pilot air supply	1	159683	MN1H-5/3E-D-1-C
		2	159695	MN1H-5/3E-D-2-C
		3	159707	MN1H-5/3E-D-3-C
	Without N1 solenoid coil ¹⁾ , normally exhausted, external pilot air supply	1	159682	MN1H-5/3E-D-1-S-C
		2	159694	MN1H-5/3E-D-2-S-C
		3	159706	MN1H-5/3E-D-3-S-C
	Without N1 solenoid coil ¹⁾ , normally pressurised, internal pilot air supply	1	159685	MN1H-5/3B-D-1-C
		2	159697	MN1H-5/3B-D-2-C
		3	159709	MN1H-5/3B-D-3-C
	Without N1 solenoid coil ¹⁾ , normally pressurised, external pilot air supply	1	159684	MN1H-5/3B-D-1-S-C
		2	159696	MN1H-5/3B-D-2-S-C
		3	159708	MN1H-5/3B-D-3-S-C

1) N1 solenoid coils → 102