

CRSMT-8M-PS-24V-K-...-...
Proximity sensor

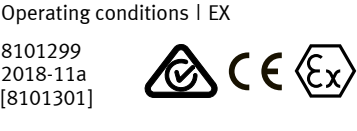
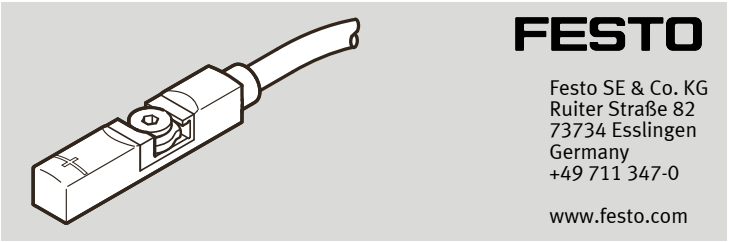

Translation of the original instructions

1 Identification EX

Table with 2 columns: Identification mark, II 3G, Ex nA IIC T4 X Gc; II 3D, Ex tc IIIC T120°C X Dc

Tab. 1

2 Applicable documents

All available documents for the product -> www.festo.com/pk.

3 Safety

3.1 Safety instructions

- The device can be used under the stated operating conditions in zone 2, explosive gas atmospheres, and in zone 22, explosive dust atmospheres.
- This product can generate high frequency interference, which may make it necessary to implement interference suppression measures in residential areas.
- Observe the specifications on the product labelling.
- All work must be carried out outside of potentially explosive areas.
- Protect the device from overheating. Mount the proximity sensor in the specified metallic sensor slot of the cylinder.
- Use the device in its original status without any unauthorised modifications.

3.2 Intended use

This product is intended for sensing the position of magnets (e.g. the piston position) in Festo products.

3.3 Identification X: special conditions

- Do not disconnect when powered.
- Use an additional strain relief for the cable.
- Protect the device from all mechanical impact.
- Protect device from UV radiation.
- Ambient temperature: -40 °C ≤ Ta ≤ +85 °C

4 Function

The CRSMT-8M-... is an electronic proximity sensor with switching status indication.

5 Installation

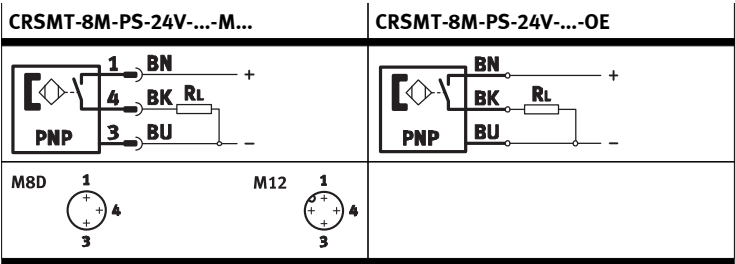

Tab. 2

6 Assembly

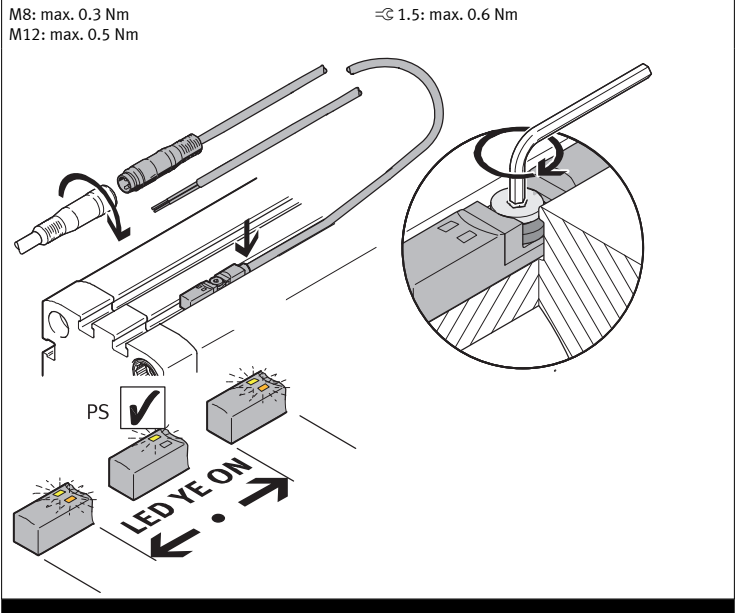

Tab. 3

Expansion

1. Loosen retaining screw.
2. Remove the proximity sensor from the slot.

7 Commissioning

WARNING!

- Electrically generated sparks can ignite a potentially explosive atmosphere and cause an explosion.
- Do not disconnect when powered.
- Prevent the disconnection of the plug M8 and/or M12 with a safety clip NEAU-M8-GD and/or NEAU-M12-GD (not included in the scope of delivery).
- Connect the device with a connecting cable outside the potentially explosive area or in a type of ignition protection suitable for zones 2 and 22.

8 Maintenance and care

The device is maintenance-free. Repairs are not possible.

9 Technical data

Table with 3 columns: Operating conditions, Materials, and various technical specifications (Operating voltage, Max. output current, Max. switching capacity, Residual current, Voltage drop, Switch-on time, Switch-off time, Repetition accuracy, Short circuit protection, Reverse polarity protection, Ambient temperature, Degree of protection, etc.)

Tab. 4